

PL55 TRIMLESS & SURFACE LED PROFILE

PL55; 55 x 41 mm

This surface ceiling LED profile has an internal design shape that provides optimised light distribution and maximum efficiency, and therefore suitable for numerous architectural ceiling projects. The LED profile comes with a choice of diffusers including opal and prismatic low glare, which creates a honeycomb effect and reduces total light loss to a minimum.

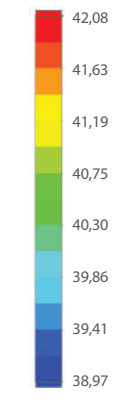
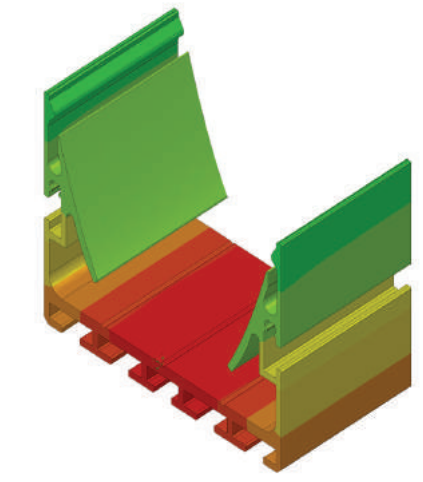
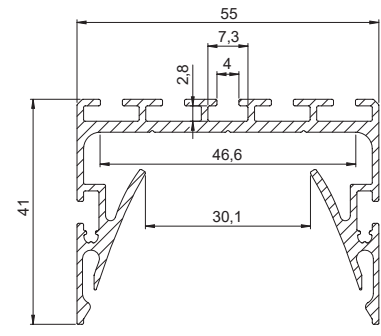

Temperature (Solid) [°C]
 Temperature ambient: 25°C
 Total power: 36 W/m (72 LEDs)



EC-PL55 End Caps

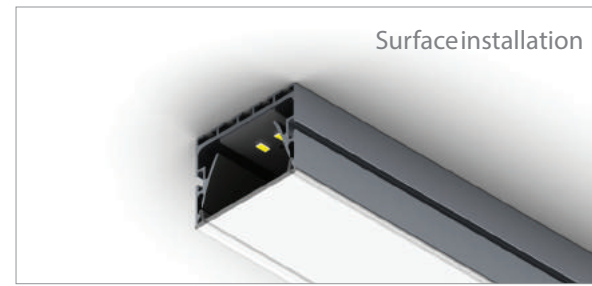

Surface installation

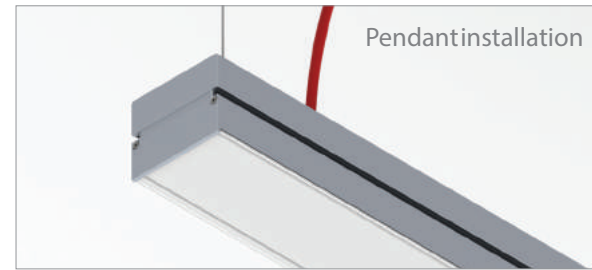

Pendant installation



Linear Connector



MC-PL55-MAG Mounting Brackets

Polar Candela Distribution Plot Using Missed Rays

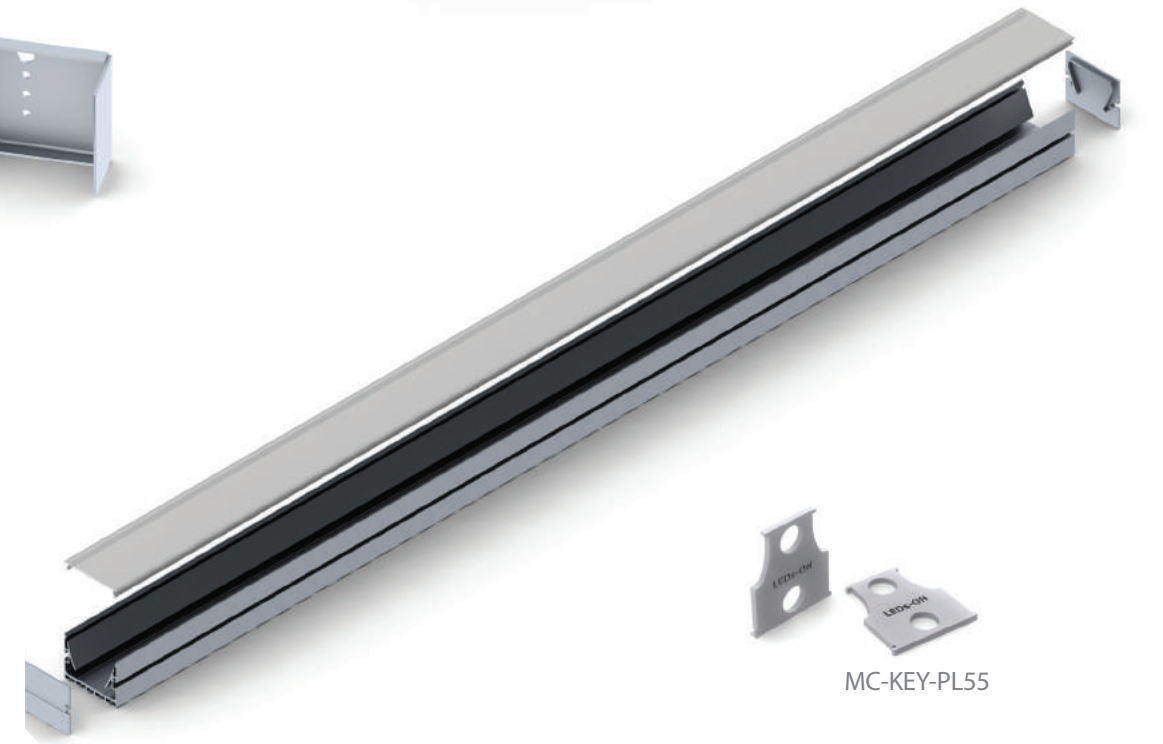
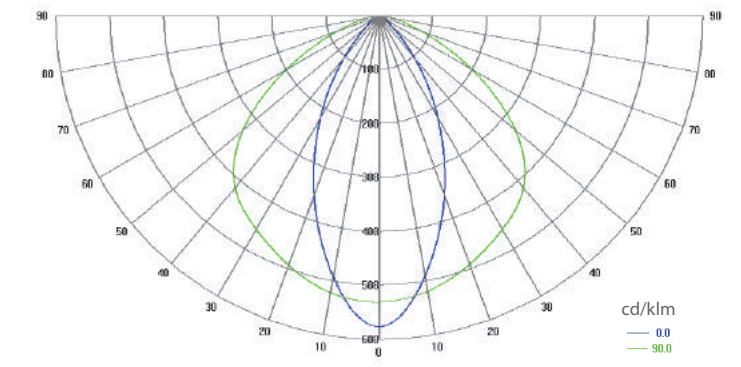

MC-KEY-PL55